

PORTAL GANTRY ROBOT

Characteristics:

The GANTRY robot is made according to buyers' requests.



PRICE
ON DEMAND



TIME OF DELIVERY
AS AGREED UPON

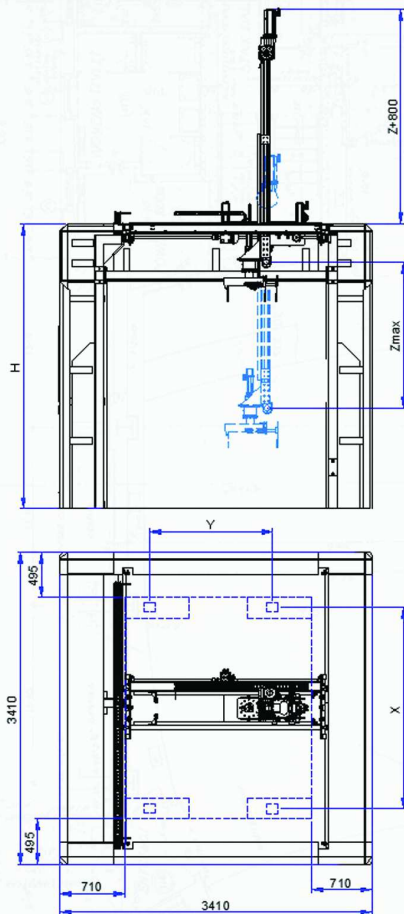

PORTAL GANTRY ROBOT

Description:

The GANTRY robot is a newly developed project from our company. The operation principle is based on 3 linear motions in directions X,Y and Z, and a single rotation around the Z axis. In this manner, grasp can be achieved within the prismatic work area defined by the X, Y and Z axis strokes.

As with any robot, depending on the type of the receiving arm, the device itself can have many purposes and can be used for:

- individual stacking of the product during the filling and palletization process,
- putting and inserting wrapping and other materials during packing,
- painting, cutting,
- moving, and other auxiliary operations, etc.

The first model is developed to palletize 20 kg packages. The palletization of packages determines precision required to stack packages, the height of palette stacking, ways of stacking and capacity, i.e. stacking rate.

Capacity depends on the number of operations other than palletization which are being done such as insertion of foils, paper sheets or other dividing panels.

The GANTRY palletizer can achieve palletization rates consistent with high production, up to 1000 packages per hour.



HEAD OFFICE (INVOICE ADDRESS):
 Liparska 50,
 21208 Sremska Kamenica,
 Srbija

PHONE: +381 21/625 28 20
FAX: +381 21/625 28 24

REPRESENTATIVE: Niko Bubić
E-MAIL: info@multi-tec.net
www.multi-tec.net

**PRODUCTION AND WAREHOUSE
 (mail and parcels address):**
 Novosadska 701, 21235 Temerin, Srbija